



Single Fixture for LED Light

EPL Single Fixture for LED Light



5 YEAR
WARRANTY

- LED T8 4ft Tube Open Commercial Light Fixture
- Heavy-Duty on/off safety switch
- Screw-On End Caps
- Fastened to Housing by Sheet Metal Screws to Assure Rigidity ; May be used as Channel Couplings.



Energy Progress Lighting

1010 Hoyt Avenue | Ridgefield, NJ 07657 | Phone: (201) 313-7194 | Fax: (201) 840-0070
Toll Free: (866) 375-7077 | Email: sales@ep-lighting.com | www.epilled.com

Features & Benefit

- Type : Open Lamp One-Light Channel for LED T8 Light Tubes
- Door Frame : 22-gauge cold-rolled steel; T-hinge, Positive-spring-loaded latch
- Finish : Baked white polyester finish / Minimum Reflectance 86%
- Construction : 22-gauge cold-rolled steel housing
- 4 ft 1Lamp Fixture Only
- Dimension : 48.5"x1.7"x0.9" / 0.6 lbs
- UL listed

PRODUCT IMAGE



PRODUCT DIMENSION

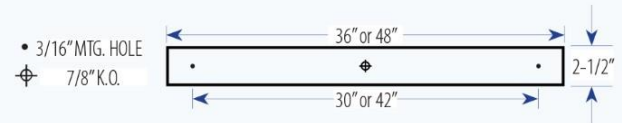
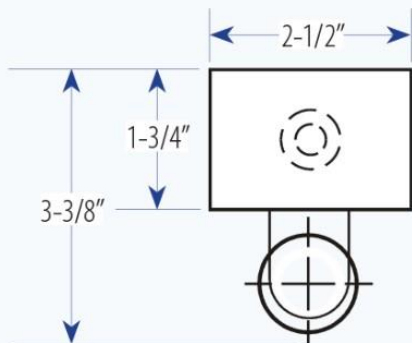

Energy Progress Lighting

1010 Hoyt Avenue | Ridgefield, NJ 07657 | Phone: (201) 313-7194 | Fax: (201) 840-0070
Toll Free: (866) 375-7077 | Email: sales@ep-lighting.com | www.epilled.com